

PERSYVEX Z90

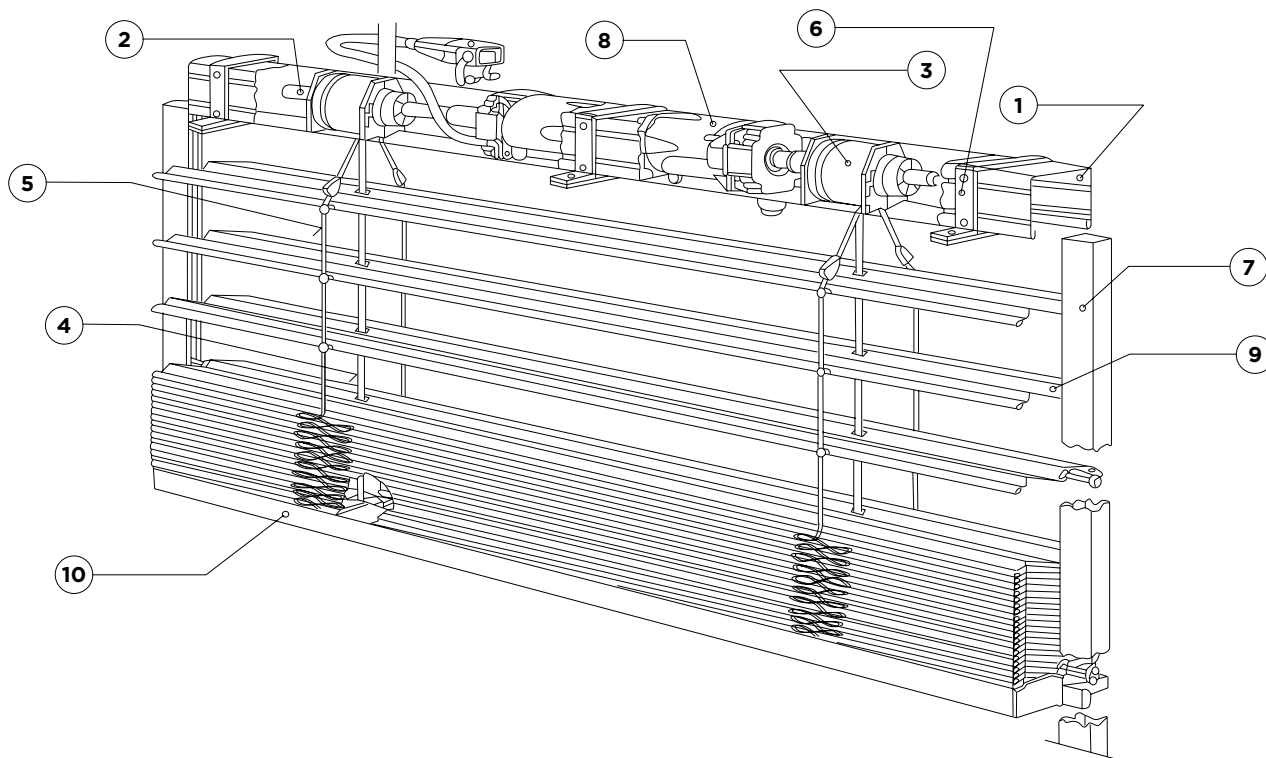

- 1. Cabezal
- 2. Eje tracción
- 3. Carrete
- 4. Cinta tracción
- 5. Cordón exterior / interior

- 6. Soporte
- 7. Guía
- 8. Motor
- 9. Lama
- 10. Terminal



Tabla de repliegue

Repliegue	Altura luz
16	80
17	100
18	120
19	140
20	160
21	180
22	200
23	220
24	240
25	260
26	280
27	300
28	320
29	340
30	360
31	380
32	400
33	420
34	440
35	460

Lama Z90

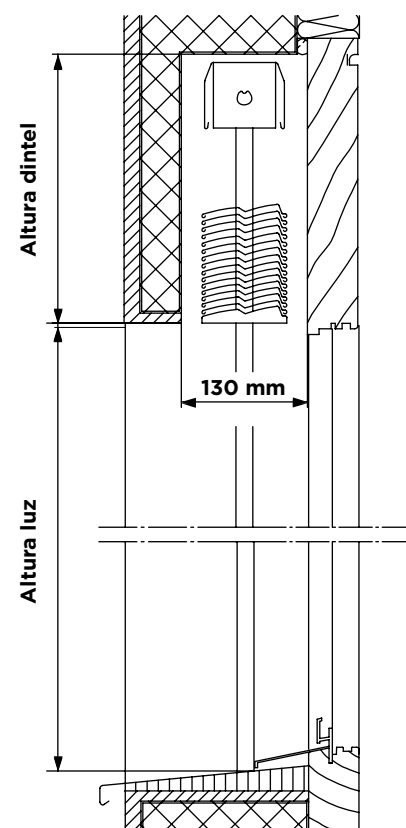
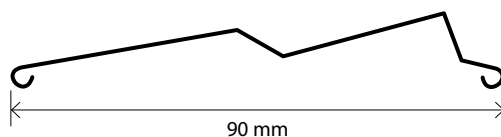

Límites dimensionales

Accionamiento	Manivela	Motor
Ancho mínimo (cm)	50	60
Ancho máximo veneciana (cm)	300	450
Alto máximo (cm)	400	450
Superficie máxima veneciana (m ²)	12	16

Aluminio Perfilado. Aleación 3105H18

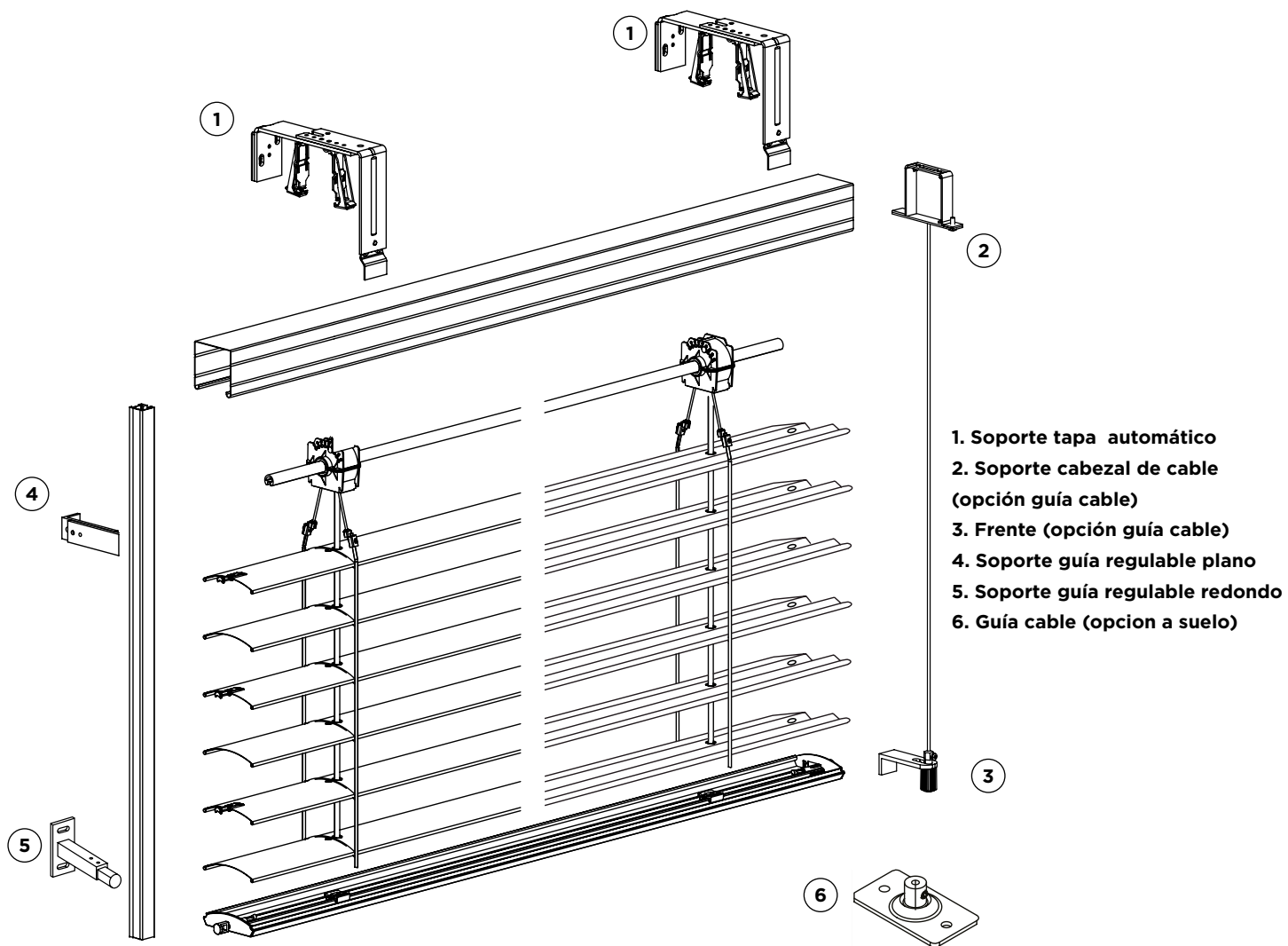

- 1. Soporte tapa automático
- 2. Soporte cabezal de cable (opción guía cable)
- 3. Frente (opción guía cable)
- 4. Soporte guía regulable plano
- 5. Soporte guía regulable redondo
- 6. Guía cable (opcion a suelo)

Guías compatibles

Guía Lateral
20 x 20 mm

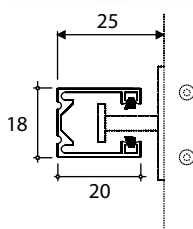

Guía Frontal
22 x 20 mm

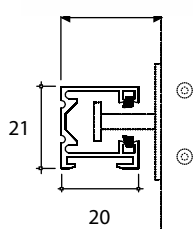

Guía Frontal
40 x 20 mm reforzada
autoportante

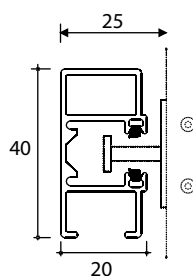

Guía Frontal Doble
40 x 22 mm

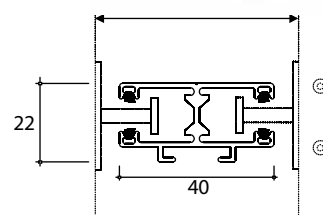

Tapas de repliegue

Tapa Simple

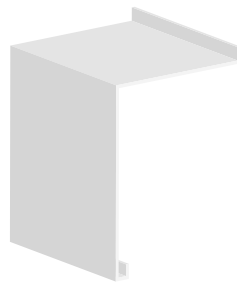

S-1



S-2



S-3

Tapa Doble

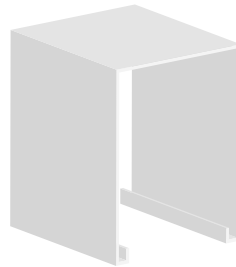

D-1

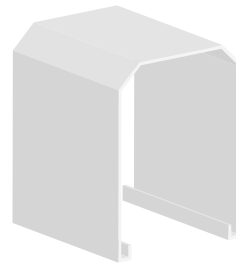

D-2

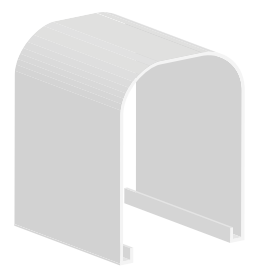

D-3

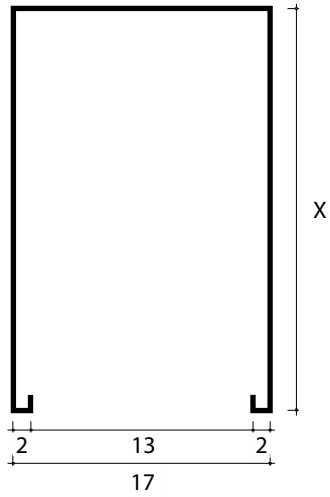

**Guía Frontal Doble
40 x 40 mm reforzada
autoportante**

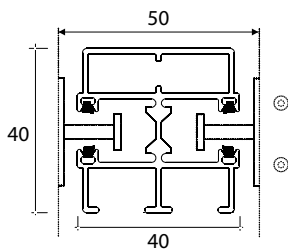

**Guía Redonda
40 mm reforzada**

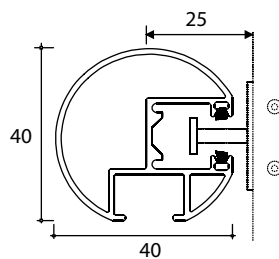

**Guía Redonda Doble
40 mm reforzada**

